

- TWO BEDROOM • CLOSE TO AMNETIES • FIRST FLOOR • CLOSE TO EDMONTON GREEN STATION •
- ATTENTION INVESTORS!!

Description

Kingsly Group Estate Agents are delighted to offer to the market this two-bedroom flat in a purpose-built block. The property benefits from two spacious double bedrooms, a family bathroom, a large bright living room, and a fully fitted kitchen. This property is currently tenanted so is suitable for buy-to-let investors only.

Location

The property is situated in an ideal location just a short walk from Edmonton Green Station (0.2 miles) Ideal for commuting into central London. The property is also a short walk from Edmonton Green Shopping Centre (0.4 miles) which offers a wide range of supermarkets, cafes, and retail stores.





Approximate Gross Internal Area
54.39 sq m / 585.44 sq ft

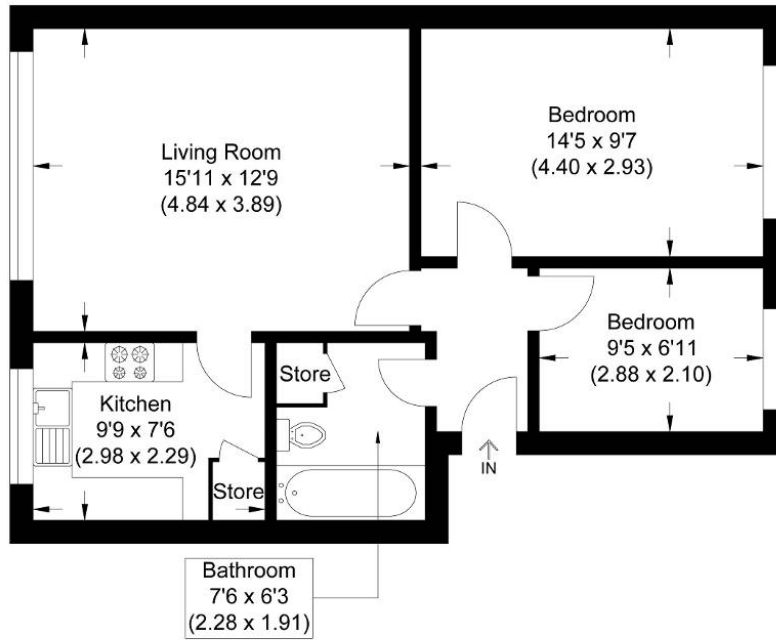

Illustration for identification purposes only, measurements are approximate, not to scale.

Energy Efficiency Rating			
Score	Energy rating	Current	Potential
92+	A		
81-91	B		84 B
69-80	C		
55-68	D	66 D	
39-54	E		
21-38	F		
1-20	G		