

- ONE BEDROOM • PURPOSE BUILT BLOCK • EXCELLENT TRANSPORT LINKS • CLOSE TO AMNETIES • FIFTH FLOOR

## Description

Kingsly is delighted to offer to the market this one-bedroom property in a purpose-built block. The property benefits from a separate kitchen, spacious living room, double bedroom, and bathroom.

## Location

The property is situated within walking distance of Hackney Central and Broadway Market which host a wide range of trendy markets, cafes, restaurants, and bars. The green open spaces of London Fields are also within walking distance (0.3 Miles)

The property also benefits from excellent transport links and is served by London Fields Overground (0.3 Miles) and Hackney Central Overground (0.4 Miles)





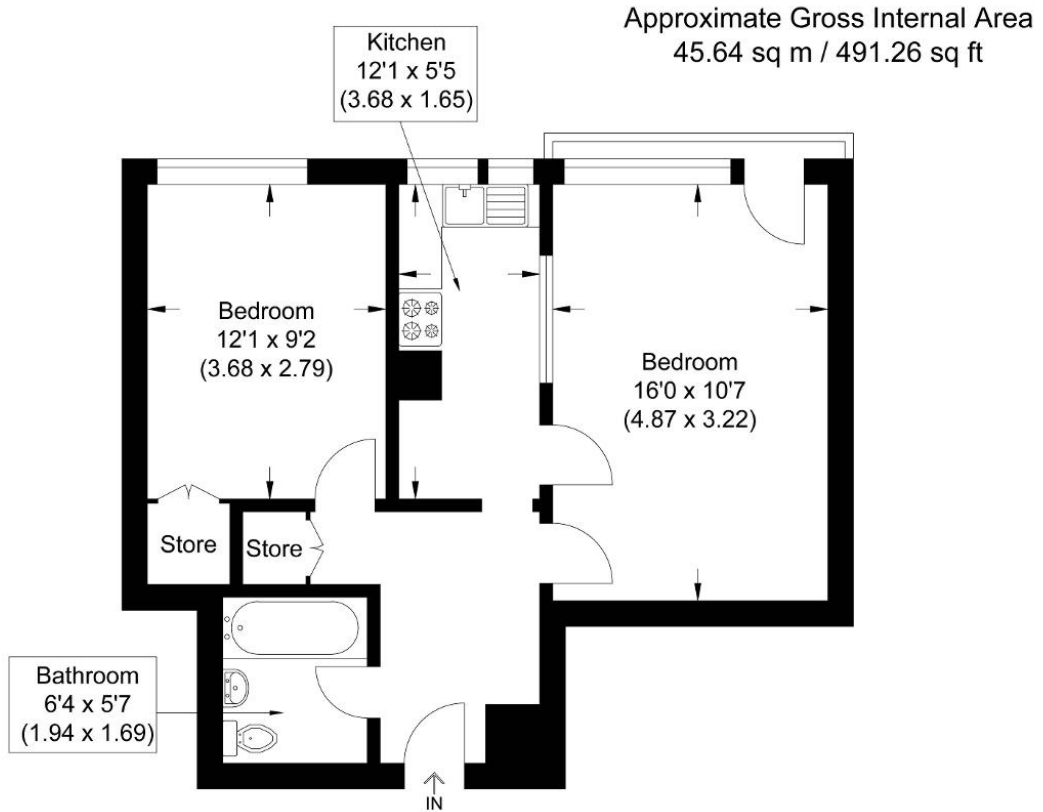

Illustration for identification purposes only, measurements are approximate, not to scale.

Energy Efficiency Rating			
Score	Energy rating	Current	Potential
92+	A		
81-91	B		
69-80	C	74   C	74   C
55-68	D		
39-54	E		
21-38	F		
1-20	G		